

PACIFIC HIGHWAY

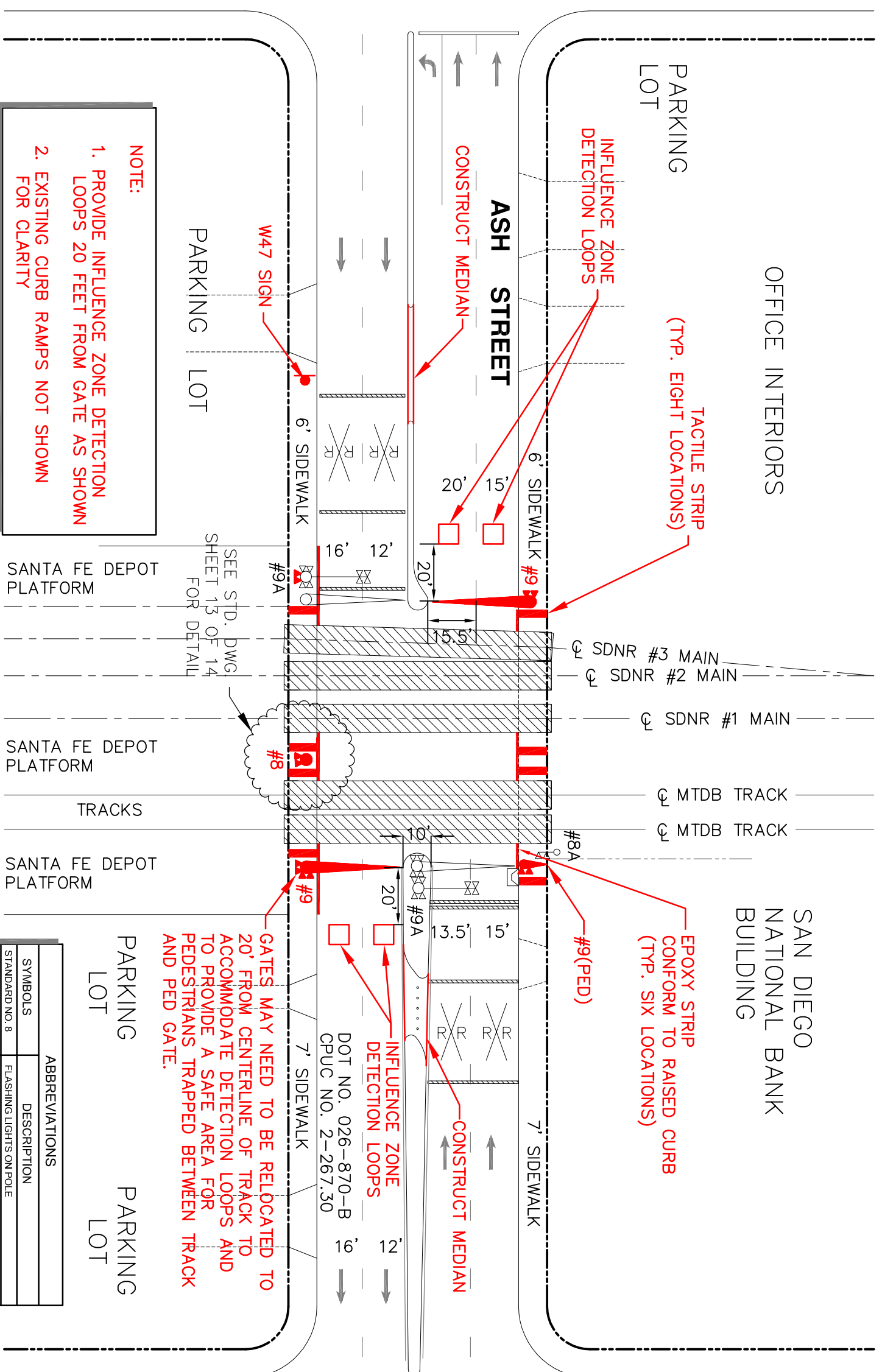

**NOTE:**  
 1. PROVIDE INFLUENCE ZONE DETECTION LOOPS 20 FEET FROM GATE AS SHOWN  
 2. EXISTING CURB RAMPS NOT SHOWN

GATES MAY NEED TO BE RELOCATED TO 20' FROM CENTERLINE OF TRACK TO ACCOMMODATE DETECTION LOOPS AND TO PROVIDE A SAFE AREA FOR PEDESTRIANS TRAPPED BETWEEN TRACK AND PED GATE.

SYMBOLS	ABBREVIATIONS	DESCRIPTION
STANDARD NO. 8	FLASHING LIGHTS ON POLE	
STANDARD NO. 8A	CANTILEVER WITH FLASHING LIGHTS	
STANDARD NO. 9	GATE WITH FLASHING LIGHTS	
STANDARD NO. 9A	GATE WITH FLASHING LIGHTS AND CANTILEVER	
STANDARD NO. 10	FLASHING LIGHT ON POLE	
SIGN W47	RAILROAD CROSSING SIGN R X R	



CONTRACT NO. 40413X1  
 DRAWING NO. GC-006  
 SCALE  
 SHEET NO. 6 OF 14

**NOT FOR CONSTRUCTION**  
 ALL DIMENSIONS ARE IN FEET (ft) UNLESS OTHERWISE NOTED

REV	DATE	DESCRIPTION	DESIGNED BY	DATE
6	11/22/05	CHANGES PER FIELD REVIEW 11/11/05 & TAAC MEETING 11/14/05	JB	
5	11/3/05	MISCELLANEOUS REVISIONS	MB	
4	7/22/05	INCORPORATE QZTT REVIEW COMMENTS	JB	
3	6/23/05	INCORPORATE QZTT REVIEW COMMENTS	JB	
2	5/26/05	INCORPORATE QZTT REVIEW COMMENTS	JB	
1	3/4/05	INCORPORATE QZTT REVIEW COMMENTS	JB	

**DOWNTOWN SAN DIEGO QUIET ZONE STUDY**

**Centre City Development Corporation**

**Korve Engineering**  
 6529 Federal Boulevard  
 San Diego, CA 92121  
 (619) 582-4982 Fax (619) 585-7488

**BDS Engineering, Inc.**  
 6529 Federal Boulevard  
 San Diego, CA 92121  
 (619) 582-4982 Fax (619) 585-7488

**ASH STREET CONCEPTUAL PLAN**

CONTRACT NO. 40413X1  
 DRAWING NO. GC-006  
 REV. 6  
 SCALE  
 SHEET NO. 6 OF 14