

PACIFIC HIGHWAY

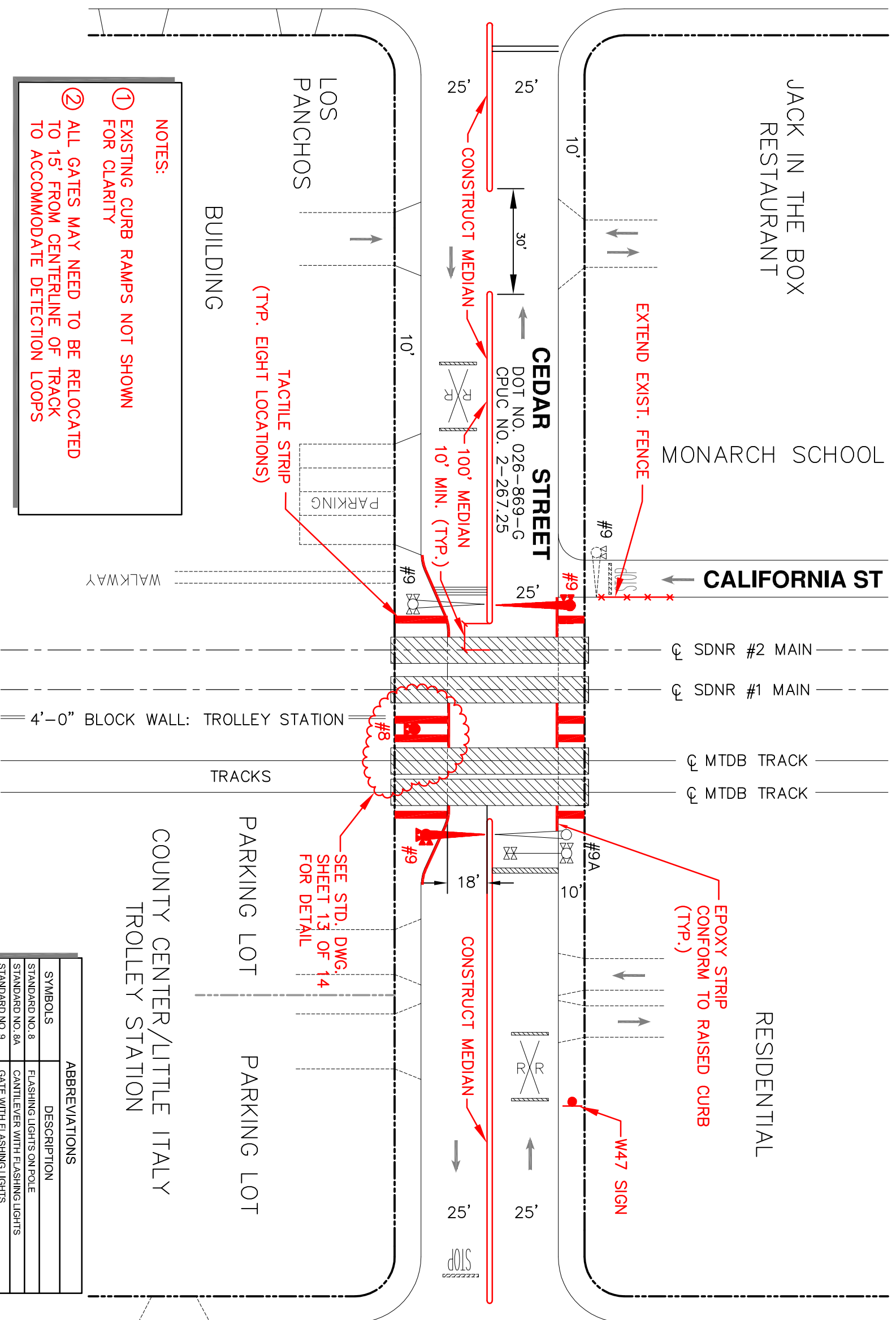

**NOTES:**

① EXISTING CURB RAMPS NOT SHOWN FOR CLARITY

② ALL GATES MAY NEED TO BE RELOCATED TO 15' FROM CENTERLINE OF TRACK TO ACCOMMODATE DETECTION LOOPS

SYMBOLS	ABBREVIATIONS	DESCRIPTION
STANDARD NO. 8	FLASHING LIGHTS ON POLE	
STANDARD NO. 8A	CANTILEVER WITH FLASHING LIGHTS	
STANDARD NO. 9	GATE WITH FLASHING LIGHTS	
STANDARD NO. 9A	GATE WITH FLASHING LIGHTS AND CANTILEVER	
STANDARD NO. 10	FLASHING LIGHT ON POLE	
SIGN W47	RAILROAD CROSSING SIGN R X R	

**NOT FOR CONSTRUCTION**

ALL DIMENSIONS ARE IN FEET (#) UNLESS OTHERWISE NOTED

REV	DATE	DESCRIPTION
6	11/22/05	CHANGES PER FIELD REVIEW 11/11/05 & TAAC MEETING 11/14/05
5	11/3/05	MISCELLANEOUS REVISIONS
4	7/22/05	INCORPORATE QZTT REVIEW COMMENTS
3	6/23/05	INCORPORATE QZTT REVIEW COMMENTS
2	5/26/05	INCORPORATE QZTT REVIEW COMMENTS
1	3/4/05	INCORPORATE QZTT REVIEW COMMENTS

DESIGNED BY	DATE
JB	10/21/05

DRAMA BY	CHECKED BY	IN CHARGE
MB	JB	JB

**Centre City Development Corporation**

**Korve Engineering**  
6859 Federal Boulevard  
San Diego, CA 92116  
(619) 582-4982 Fax (619) 585-7488

**BDS Engineering, Inc.**  
Civil Engineering  
6859 Federal Boulevard  
San Diego, CA 92116  
(619) 582-4982 Fax (619) 585-7488

**DOWNTOWN SAN DIEGO QUIET ZONE STUDY**

**CEDAR STREET CONCEPTUAL PLAN**

CONTRACT NO. 40413X1  
DRAWING NO. GC-004  
SCALE  
SHEET NO. 4 OF 14

