

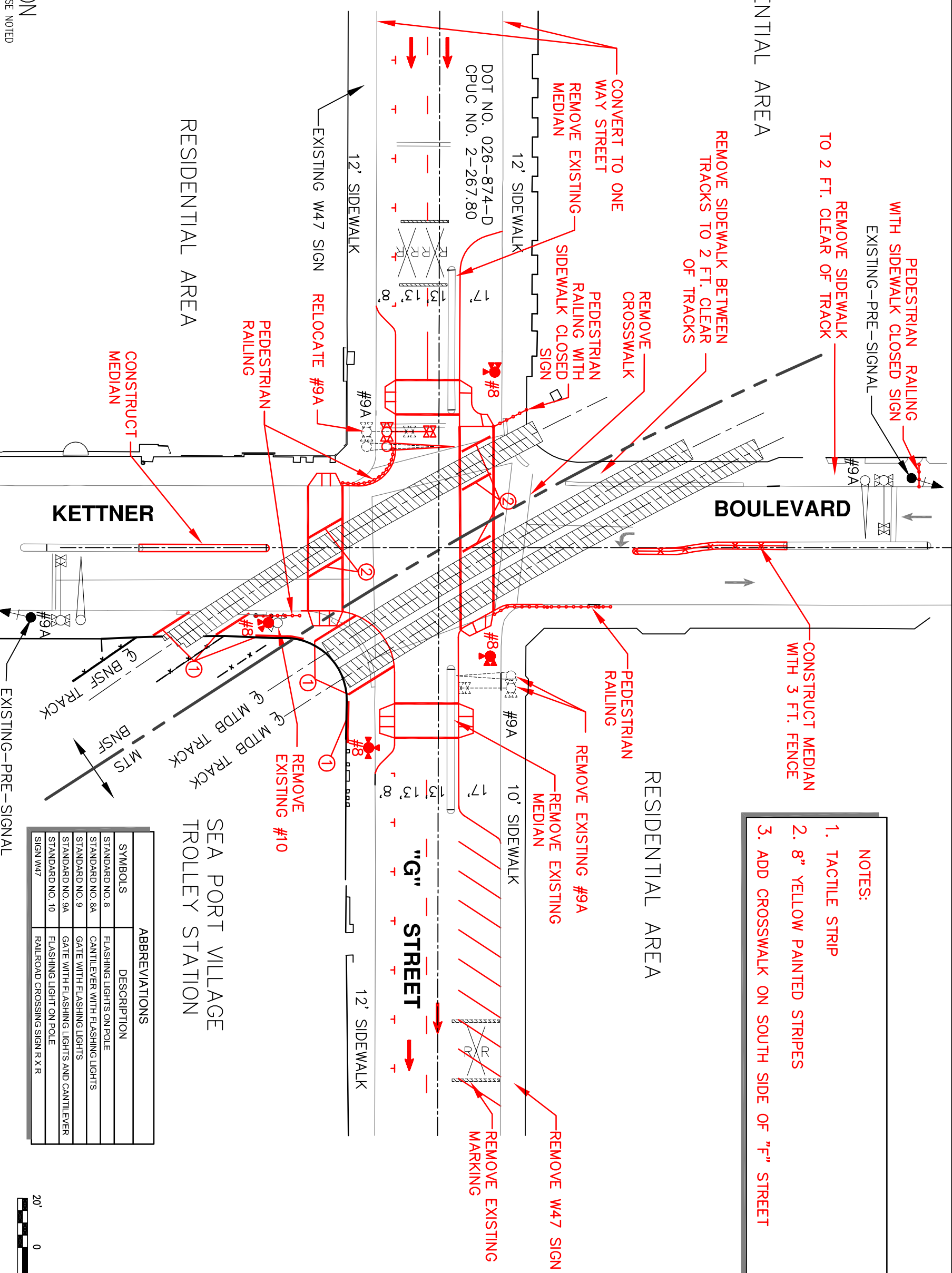

RESIDENTIAL AREA

PEDESTRIAN RAILING WITH SIDEWALK CLOSED SIGN EXISTING - PRE-SIGNAL  
 REMOVE SIDEWALK TO 2 FT. CLEAR OF TRACK  
 REMOVE SIDEWALK BETWEEN TRACKS TO 2 FT. CLEAR OF TRACKS



- NOTES:**
1. TACTILE STRIP
  2. 8" YELLOW PAINTED STRIPES
  3. ADD CROSSWALK ON SOUTH SIDE OF "F" STREET

**NOT FOR CONSTRUCTION**  
 ALL DIMENSIONS ARE IN FEET (ft) UNLESS OTHERWISE NOTED

REV	DATE	DESCRIPTION
1	3/4/05	INCORPORATE QZTT REVIEW COMMENTS
2	5/26/05	INCORPORATE QZTT REVIEW COMMENTS
3	6/23/05	INCORPORATE QZTT REVIEW COMMENTS
4	7/22/05	INCORPORATE QZTT REVIEW COMMENTS
5	11/3/05	MISCELLANEOUS REVISIONS

DESIGNED BY	DATE
JB	10/21/05

DESIGNED BY	DATE
JB	10/21/05

DESIGNED BY	DATE
JB	10/21/05

DESIGNED BY	DATE
JB	10/21/05

SYMBOLS	ABBREVIATIONS
STANDARD NO. 8	FLASHING LIGHTS ON POLE
STANDARD NO. 8A	CANTILEVER WITH FLASHING LIGHTS
STANDARD NO. 9	GATE WITH FLASHING LIGHTS
STANDARD NO. 9A	GATE WITH FLASHING LIGHTS AND CANTILEVER
STANDARD NO. 10	FLASHING LIGHT ON POLE
SIGN W47	RAILROAD CROSSING SIGN R X R



DOWNTOWN SAN DIEGO QUIET ZONE STUDY

SEA PORT VILLAGE TROLLEY STATION

CONTRACT NO. 40413X1  
 DRAWING NO. GC-008  
 SCALE  
 SHEET NO. 8 OF 14

Centre City Development Corporation

KETTNER BLVD. & "G" STREET CONCEPTUAL PLAN

Korve Engineering  
 6529 Federal Boulevard  
 Land Surveyors  
 (919) 982-4992 Fax (919) 982-7488

BDS Engineering, Inc.  
 6529 Federal Boulevard  
 Land Surveyors  
 (919) 982-4992 Fax (919) 982-7488